

PLAN MECHANICAL VIEW

02.0-ODC-TS-S (WITH CASTERS, SELF-CONTAINED)

GILA

QTY	DESCRIPTION	PART NUMBER	VOLTAGE	PHASE	AMPS	TOTAL AMPS
1	23" LED 3500K, FROSTED, 24V	LG-FX-XXX-X	115V	1	0.04	0.04
1	EVAPORATOR FAN	RF-FA-XXXX	115V	1	0.17	0.17
1	CONDENSATE EVAP PAN / 800W / HALF	EL-EV-XXXX	115V	1	6.90	6.90
1	CONDENSING UNIT	RF-CU-0499-A	115V	1	8.30	8.30

CIRCUIT#1 TOTAL AMPS: 15.41 VOLTAGE: 115/1/60 CONNECTION: 5-20P ANGLE
 PACKOUT VOLUME: 3.07 CUBIC FT.
 INTERNAL VOLUME: 6.32 CUBIC FT.

* OPTIONAL COMPONENT LOAD INCLUDED

CONFORMS TO UL STD 471.
 CONFORMS TO NSF STD 7.
 CERTIFIED TO CAN/CSA STD
 C22.2 NO. 120.

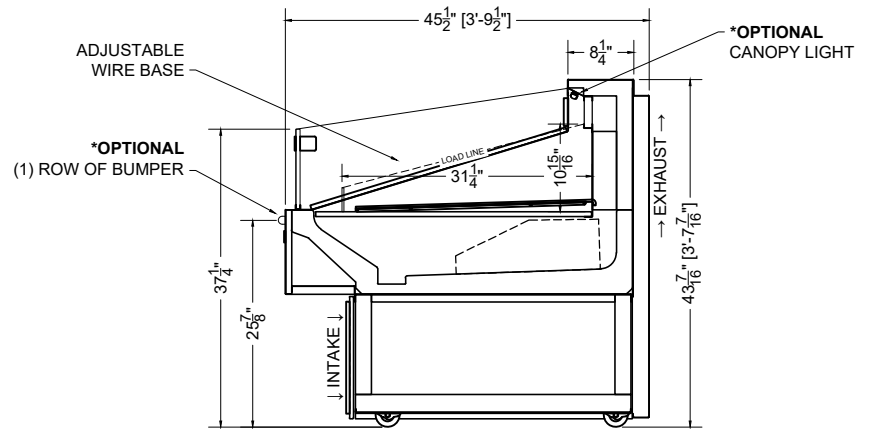

SECTION VIEW

