

07.8-FLX-PX02-S (WITH CASTERS, SELF-CONTAINED)

WILLOW

QTY	DESCRIPTION	PART NUMBER	VOLTAGE	PHASE	AMPS	TOTAL AMPS
3	EVAPORATOR FAN	RF-FA-XXXX	115V	1	0.17	0.51
1	CONDENSING UNIT	RF-CU-0383-A	115V	1	12.10	12.10
1	CONDENSATE EVAP PAN / 1200W / FULL	EL-EV-XXXX	115V	1	10.00	10.00

CIRCUIT#1

TOTAL AMPS:22.61

VOLTAGE:115/1/60

CONNECTION:L5-30P

PACKOUT VOLUME: 18.64 CUBIC FT.  
INTERNAL VOLUME: 24.06 CUBIC FT.

CONFORMS TO UL STD 471.  
CONFORMS TO NSF STD 7.  
CERTIFIED TO CAN/CSA STD C22.2 NO. 120.

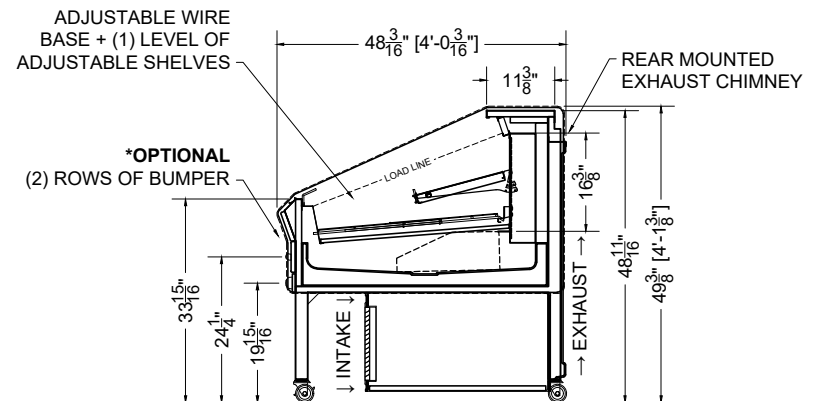
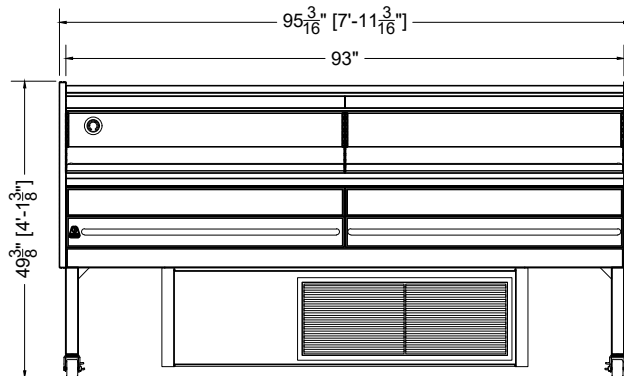
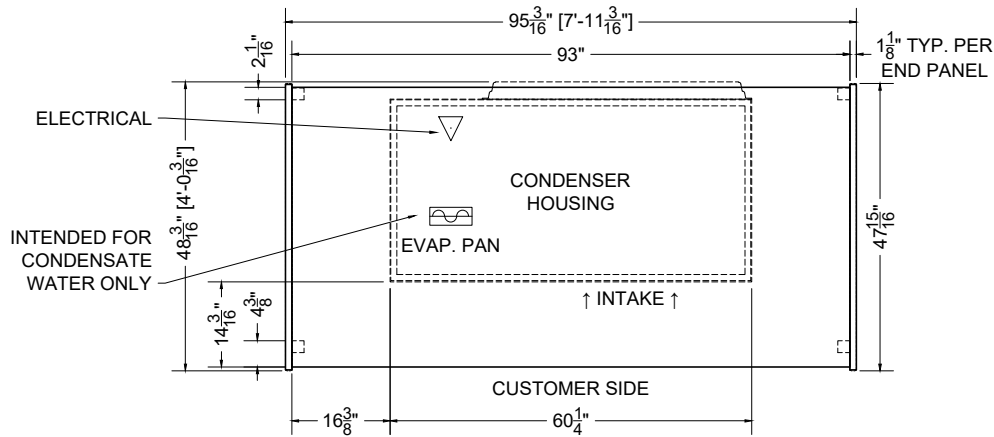

PROJ SPECIFICATION SHEET

Des 07.8-FLX-PX02-S Mobile Produce Display (W/ CASTERS, S/C)

Name AME Dwg# 038556 Rev #02- 06/14/24

CONFIDENTIAL DOCUMENT: THIS DRAWING IS CONFIDENTIAL AND THE PROPERTY OF SOUTHERN CASEARTS, INC AND IS NOT TO BE REPRODUCED OR EXCHANGED WITH ANY OTHER PERSON OR COMPANY WITHOUT THE EXPRESS WRITTEN CONSENT OF SOUTHERN CASEARTS, INC.

COPYRIGHT ©2024 SOUTHERN CASEARTS, INC. ALL RIGHTS RESERVED

3/8" = 1"

DRAWING DETAILS SUBJECT TO CHANGE DURING THE ENGINEERING PROCESS



SOUTHERN CaseArts