

12.1-FSE-HCI3-H

QTY	DESCRIPTION	PART NUMBER	VOLTAGE	PHASE	AMPS	TOTAL AMPS	L1	L2
18	12" LED 3500K, FROSTED, 24V	LG-FX-XXX-X	115V	1	0.02	0.36	0.36	---
6	23" LED 3500K, FROSTED, 24V	LG-FX-XXX-X	115V	1	0.04	0.24	0.24	---
18	29" LED 3500K, FROSTED, 24V	LG-FX-XXX-X	115V	1	0.05	0.90	0.90	---
8	FOIL HEATER, SHELF, 5"	FS-HT-0507-A	208V	1	4.50	36.00	36.00	36.00
8	FOIL HEATER, CUSTOMER LEFT	FS-HT-0962-A	208V	1	2.02	16.16	16.16	16.16
8	FOIL HEATER, CUSTOMER RIGHT	FS-HT-0963-A	208V	1	2.02	16.16	16.16	16.16
8	FOIL HEATER, RADIUS END	FS-HT-0964-A	208V	1	1.78	14.24	14.24	14.24

CIRCUIT#1 (LOAD CENTER) TOTAL AMPS:(L1 = 84.06 / L2 = 82.56) VOLTAGE:208/1160, 3-WIRE CONNECTION:HARDWIRED

CONFORMS TO UL STD 197.  
CONFORMS TO NSF STD 4.  
CERTIFIED TO CAN/CSA STD  
C22.2 NO. 120.

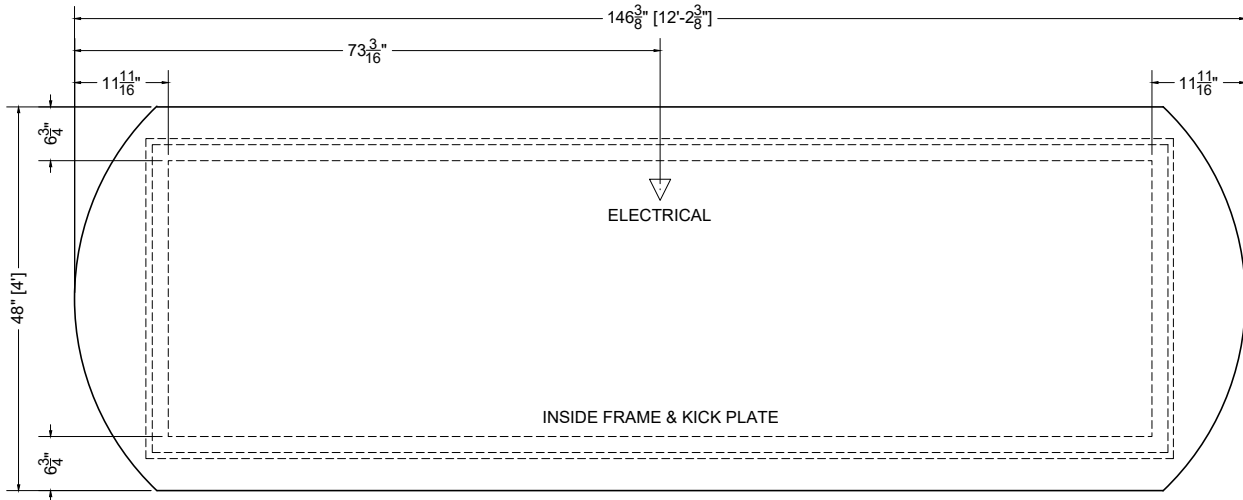

PLAN MECHANICAL VIEW

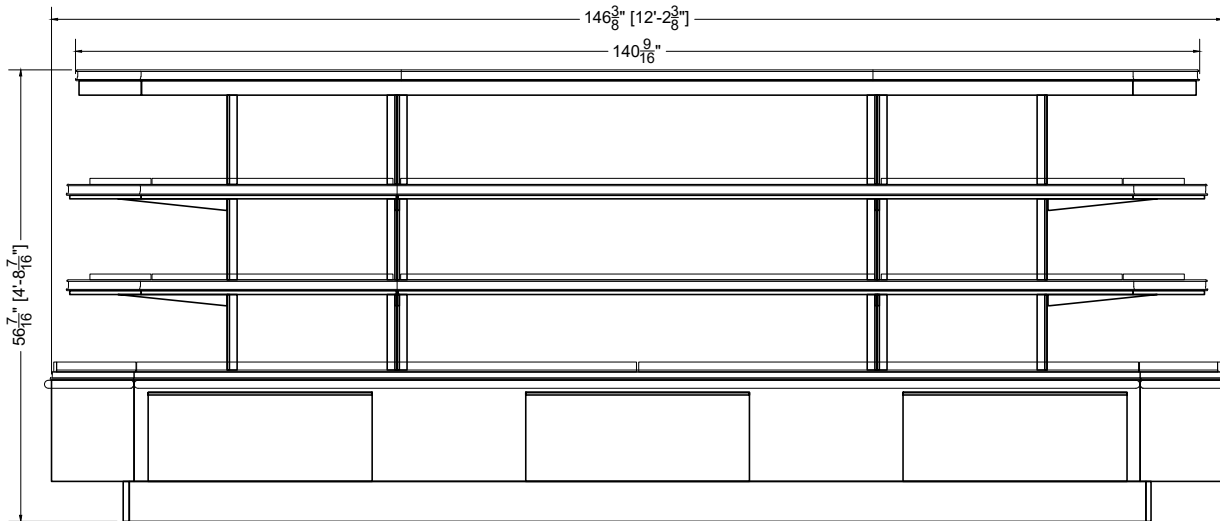

SIDE VIEW

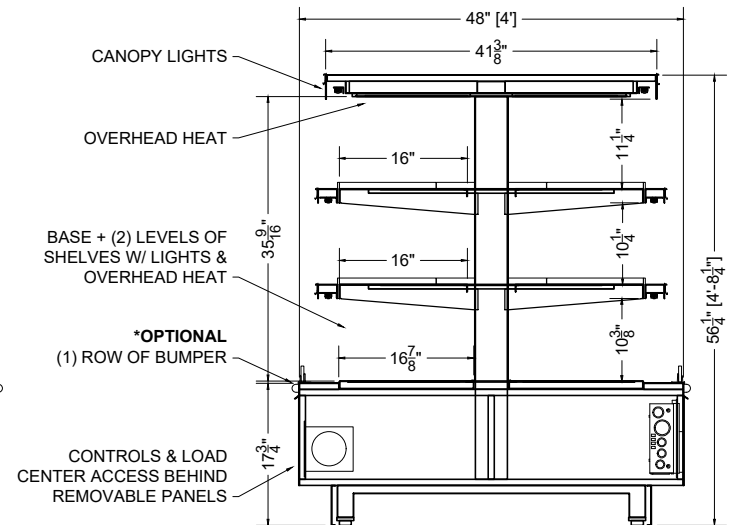

SECTION VIEW

