

CONFORMS TO UL STD 197.  
CONFORMS TO NSF STD 4.  
CERTIFIED TO CAN/CSA STD  
C22.2 NO. 120.



HITT-2SS

POWELL

QTY	DESCRIPTION	PART NUMBER	VOLTAGE	PHASE	AMPS	TOTAL AMPS
8	18" LED 4100K, FROSTED, 24V	LG-FX-XXX-X	120V	1	0.12	0.93
10	OVERHEAD HEAT, CERAMIC	---	208V	1	1.20	12.02
1	SHELF HEAT PAD	---	208V	1	3.65	3.65
1	BASE HEAT PAD	---	208V	1	4.47	4.47

CIRCUIT#1 TOTAL AMPS:21.08  
SHIPPING DIMENSIONS: 86" X 44" X 83"  
WEIGHT: 596 LBS

VOLTAGE:208-230/1/60, 3-WIRE CONNECTION:L14-30P  
SHELF HEATED AREA: 1792 SQ. IN.  
BASE HEATED AREA: 2304 SQ. IN.  
TOTAL HEATED SURFACE AREA: 4096 SQ. IN.

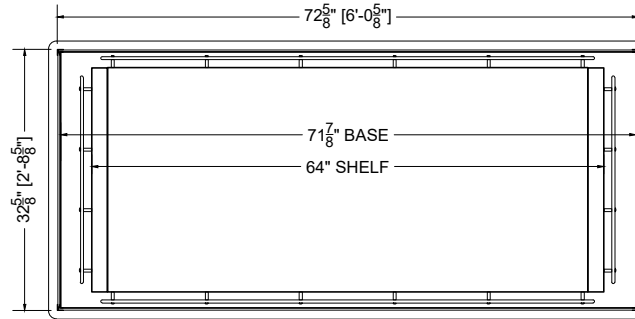

PLAN VIEW

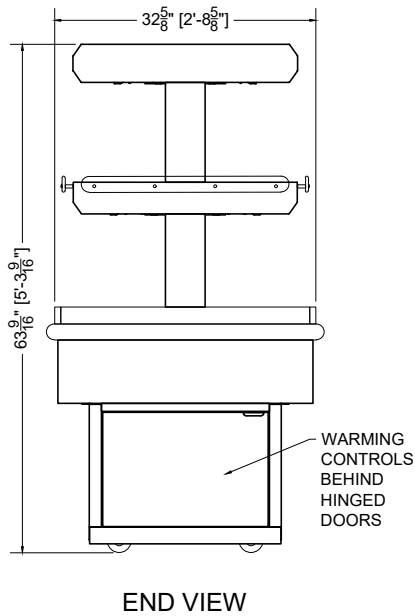

END VIEW

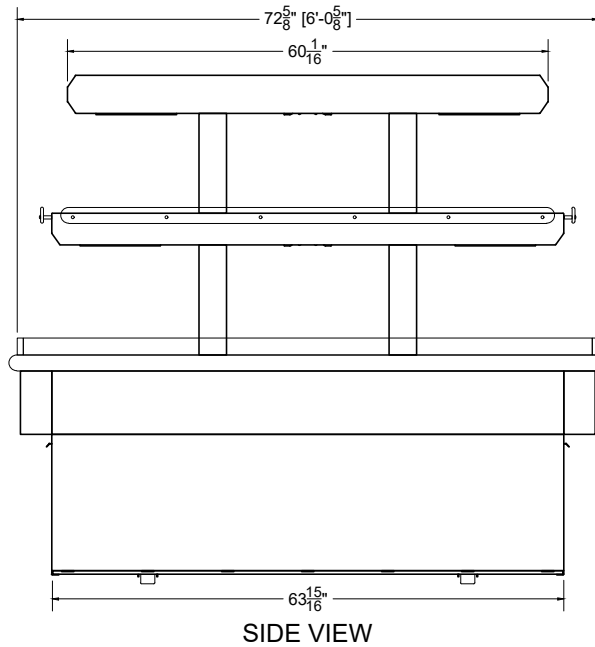

SIDE VIEW

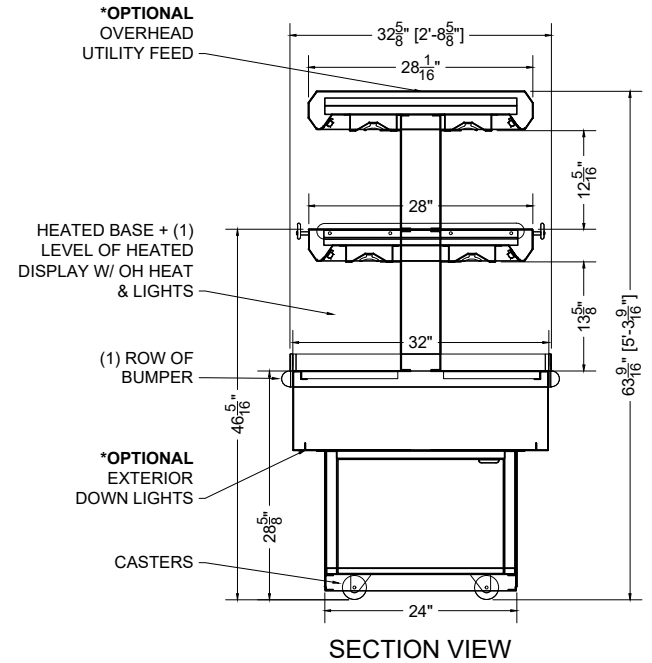

SECTION VIEW

PROJ SPECIFICATION SHEET

Des: HITT-2SS Mobile Hot Display (TWIN TIER)

Name: AME Dwg#: 038433 Rev: #01- 05/02/24

CONFIDENTIAL DOCUMENT: THIS DRAWING IS CONFIDENTIAL AND THE PROPERTY OF SOUTHERN CASEARTS, INC AND IS NOT TO BE REPRODUCED OR EXCHANGED WITH ANY OTHER PERSON OR COMPANY WITHOUT THE EXPRESS WRITTEN CONSENT OF SOUTHERN CASEARTS, INC.

COPYRIGHT ©2022 SOUTHERN CASEARTS, INC. ALL RIGHTS RESERVED

1/2" = 1'

DRAWING DETAILS SUBJECT TO CHANGE DURING THE ENGINEERING PROCESS



SOUTHERN CaseArts